

TRIOFLOR[®]

Shell[™]

SPC Flooring



Shell SPC flooring is completely waterproof, indentation resistance and durability, while reducing sound transmission.

The free of plasticizer technology make Shell SPC flooring extremely stability, high performance.

The patented surface treatment technology Diamond Core make Shell SPC.

A. Anti-scratch, pet-free

With fortifier in UV, our DIAMOND surface treatment performs better in anti-scratch function.

B. Abrasion resistance

With fortifier in wear layer, abrasion coefficient of our wear layer is 1500R more than regular wear layer of same thickness from other suppliers.

C. Anti-bacteria

DIAMOND surface treatment is effective in preventing Grape globular bacteria, Escherichia and fungi etc.





SW 4301



SW 4302



SW 4303



SW 4304



SW 4305





SW 4306



SW 4307

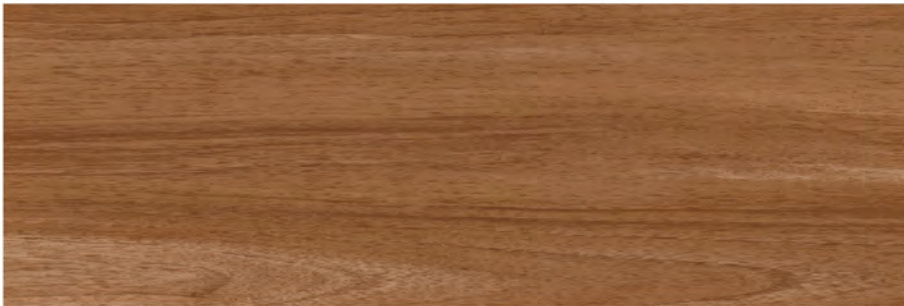

SW 4308



SW 4309



SW 4310

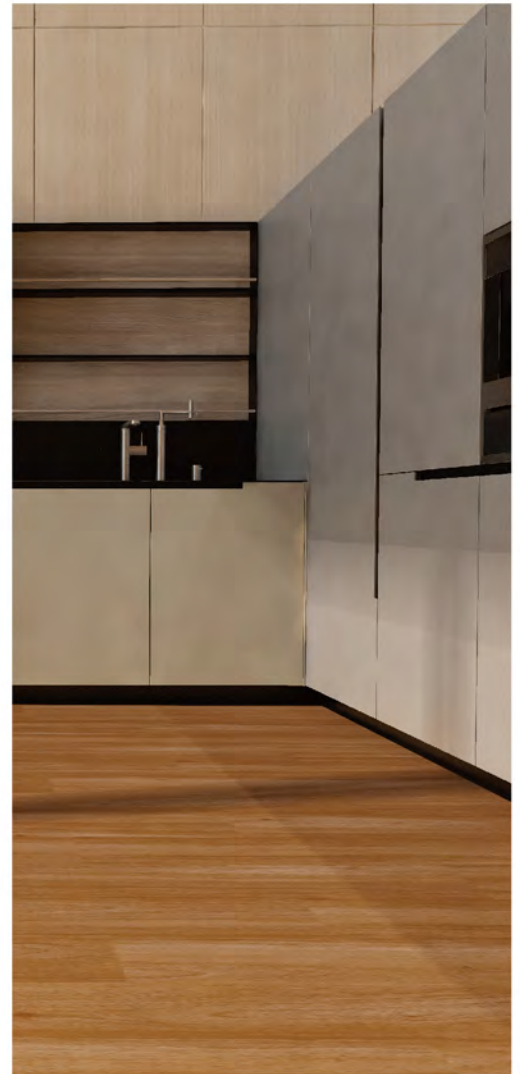



SR 4311



SR 4312



SR 4313



SR 4314

TECHNICAL DATA

TRIOFLOR	Shell™ SPC FLOORING			
DESCRIPTION	Testing Method	Unit	Shell 40	Shell 45
Length	EN ISO 24342	mm	1219.2	1219.2
Width	EN ISO 24342	mm	183	183
Overall Thickness	EN ISO 24346	mm	4	4.5
Thickness of Wear Layer	EN ISO 24340	mm	0.3	0.5
Aperture between two planks	Filler gauge	mm	≤0.13	≤0.13
Straightness	EN ISO 24342	mm	≤0.2	≤0.2
Squareness	EN ISO 24342	mm	≤0.2	≤0.2
Curling after exposure to heat	EN 434	mm	"Average of 3 specimens≤0.5mm (80 °C 6h)"	"Average of 3 specimens≤0.5mm (80 °C 6h)"
Dimensional stability after exposure to heat (%)	EN 434	-	Average of 3 specimens≤0.05% (80 °C 6h)	"Average of 3 specimens≤0.05% (80 °C 6h)"
Peeling strength of layer	EN 431	-	≥80N/5cm	≥55N/5cm
Effect of castor chair	EN 425	-	No disturbance to the surface	No disturbance to the surface
Abrasion Resistance	EN 660-2	-	≤0.015g/100wheels	≤0.015g/100wheels
Scratch-resistant	ISO 1518-1:2011	-	≥2500g	≥2500g (weights)
Glossiness	Gloss meter	-	±2gu	N/A
UV Adhesion	GBT9286	-	100%	100%
Click tensile strength	Electronic tension tester	-	2G/240N/5cm	2G/240N/5cm
		-	5Gi/160N/5cm	5Gi/160N/5cm
UV Coating	-	-	Diamond Core	Diamond Core
Residual Indentation	EN 433	-	≤0.03mm	≤0.03mm
Color Fastness/Grade	EN ISO 105-B02	Degree	≥6	≥6
Fire Rating	EN 13501-1	-	Bfl-S1	Bfl-S1
European Classification	EN 685	-	23-31	23-33-42
Underfloor heating	-	-	suitable	suitable
TOVC after 28 days	ISO 16000-6	µg/m ³	<10	<10

